

Pier Pavilion: Start of works

A spectacular public landmark is coming to Watermans Cove, Barangaroo. Pier Pavilion will be a place where people can shelter, meet, gather, and relax by the water, or enjoy a range of temporary, programmed events.

Upcoming works

Construction is expected to commence on **Monday 18 March** (weather permitting). In this initial stage, Stephen Edwards Constructions (SEC) will:

- establish the site
- erect tree protection
- install and secure timber hoarding, fencing and site signage
- modify public domain (pedestrian and cyclist pathways)
- commence demolition works.

Hours of work

These works will occur within the permitted hours:

- **Monday to Friday:** 7.30am - 5.30pm. High noise emission appliances, plant and/or machinery* will not be used between 12pm – 2pm or before 9:30am.
- **Saturday:** 7.30am - 3.30pm. High noise emission appliances, plant and/or machinery* will not be used before 9:30am or after 1:30pm.

* High noise emission appliances include machinery such as piledrivers, rock breakers and hydraulic hammers.



Artist impression of the new Pier Pavilion (view from Cirrus Dining)

What to expect

There will be:

- closure of public access to parts of the pier near Watermans Cove
- increased light vehicle and truck movements travelling across the public domain accessing the site
- mobile plant to deliver construction site equipment and lift site sheds into position
- construction material deliveries by heavy vehicles
- intermittent impacts to pedestrian movements through the area as delivery trucks arrive on site. The map below shows the temporary access for pedestrians (arrows marked **blue**) while vehicles are accessing the site. To manage public safety during these deliveries, vehicle escorts will be onsite. Additionally, there will be signage and barriers to assist the public.
- intermittent periods of noisy work (not during respite periods), for instance:
 - pavers will be removed using excavator(s) plus bobcat or similar
 - the heights of sandstone blocks north of the Pavilion will be modified, using a wet saw.

Vehicle/pedestrian movements during hoarding installation

Hoarding will be permanently installed around the perimeter of the construction site (marked in **red**). The majority of hoarding will be made of timber panels and provides public safety and site security.

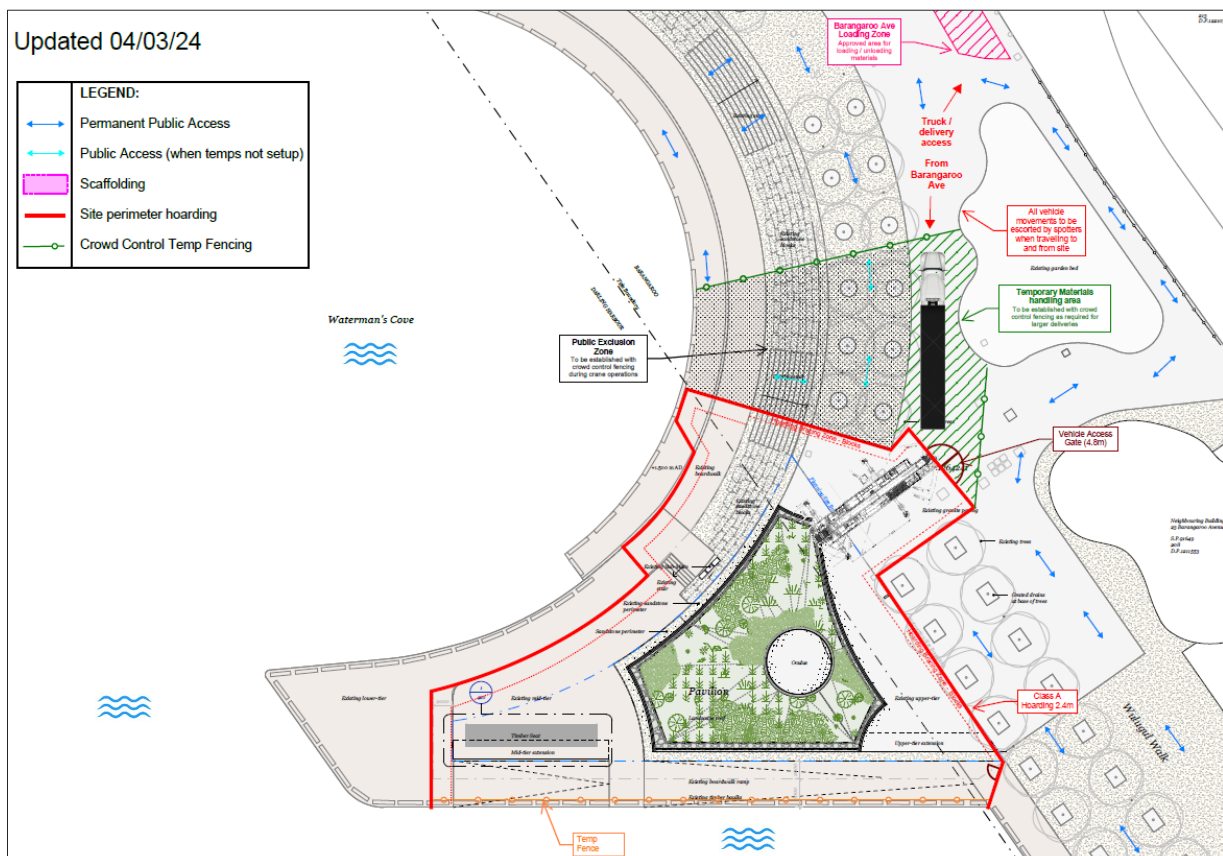



Learn more

- Pier Pavilion [webpage](#)
- Noticeboard for [Community and neighbours](#) updated with construction updates, where required
- For regular Barangaroo development and construction updates, [subscribe](#) to the mailing list.

Contact us

We are committed to keeping you informed and regular updates will be provided.

Contact us for construction related questions, feedback or complaints:

 +61 2 9216 5700  barangaroo.info@infrastructure.nsw.gov.au  barangaroo.com